

Santa María de Saúca de Guadalajara

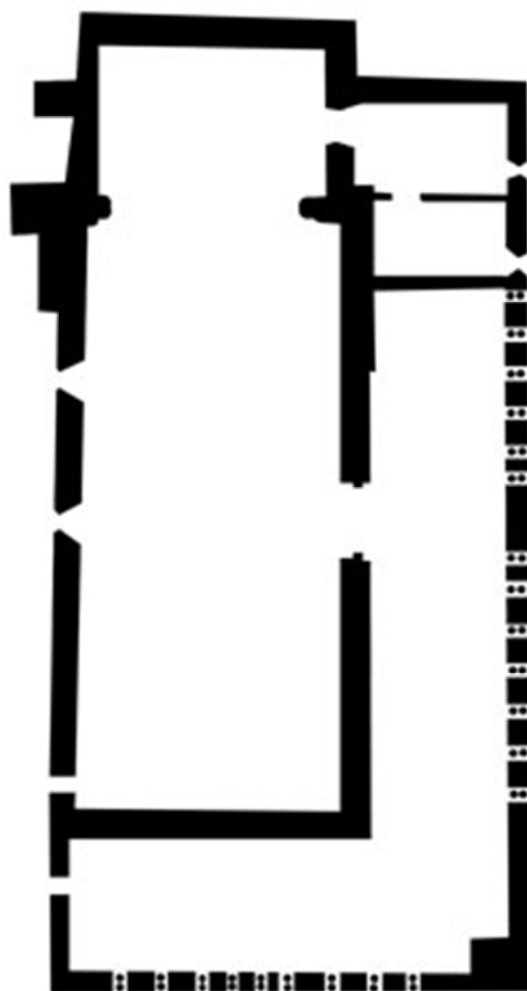

			ALFA	CANTEROS	MARIA
	TOTAL	% total	A	☐	Angr.
PARED OESTE INT.	24	25%		63%	38%
PARED SUR INT.	43	44%		2%	98%
PARED OESTE EXT.	5	5%			100%
PARED SUR EXT.	25	26%	4%	16%	80%
TOTAL	97		1	20	76
%		100%	1%	21%	78%

SIGNIFICANT SIGNS

- This arcaded gallery has a 78% of Anagrams of Mary over the total signs.
- Probably, there is a relationship between the name of the Church and the predominant sign of Mary.
- It is a small rural church of the late twelfth and thirteenth century built under the patronage of the Sigüenza Bishop Don Rodrigo. Just two capitals, one of them it is the Annunciation of Mary.