

# Monasterio Santa María de Gradefes

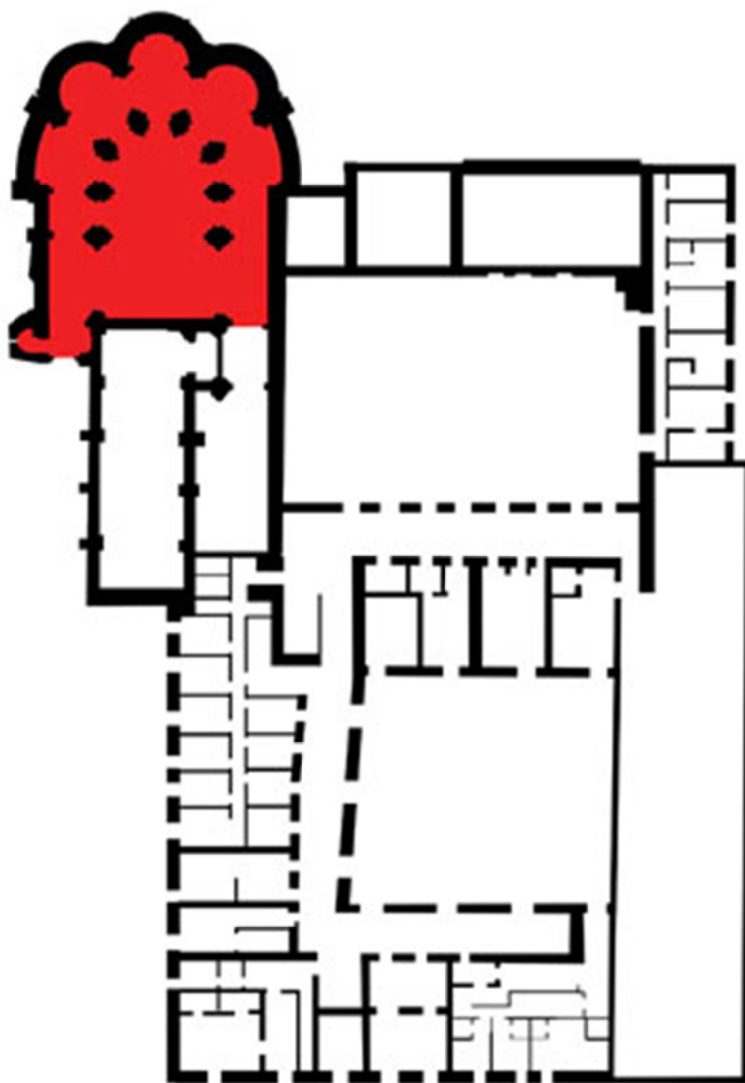

			PATER	FILIUS	SPIRITUS	ALFA	OMEGA	CIELO	PODER	INCENSARIO			
	TOTAL	% total	P	✠	F	Z	A	B	ω	Δ	☿	e	U
ABSIDES	679	50%	13%	8%		3%	4%	12%		3%	6%	22%	
COLUMNAS GIROLA	532	39%	22%	5%	7%	2%	15%	6%	13%	4%	3%	9%	5%
COLUMNAS NAVE	150	11%	20%	4%	13%	3%	4%	10%	10%	6%	5%	2%	15%
<b>TOTAL</b>	<b>1361</b>		<b>237</b>	<b>88</b>	<b>50</b>	<b>34</b>	<b>113</b>	<b>131</b>	<b>84</b>	<b>51</b>	<b>60</b>	<b>202</b>	<b>47</b>
<b>%</b>		<b>100%</b>	<b>17%</b>	<b>6%</b>	<b>4%</b>	<b>2%</b>	<b>8%</b>	<b>10%</b>	<b>6%</b>	<b>4%</b>	<b>4%</b>	<b>15%</b>	<b>3%</b>

## SIGNIFICANT SIGNS

- Trinitas 5%, Pater 17%, Filius 13%, Spiritus 3%, Alfa 8%, Omega 16%, Ecclesia 3%, Heaven's Door 4%, Power 19%, Censer 3%.
- Maria is almost absent. Stonemasons are absent. Pater, Crosier, Omega, and Alfa predominate.
- Crosier, Pater, and Omega predominate in Apses
- Pater, Alfa, and Omega predominate in Ambulatory Columns.
- Pater, Censer, Filius F, and Omega predominate on Nave Columns.
- It is a female Cistercian Abbey. It built the head and part of Cloister only. It has beautiful proportions and pretty natural lighting inside.
- Crosier represented by a spiral. The Key is of the XIII century type
- It has a big quantity of Royal Crown sign, 27 times. Fleur de Lis is also represented. There are excellent dove heads.
- Signs are of high quality and good technique.
- There are 13 signs of fish represented schematically like in primitive Christianity
- . The fish name in Greek is equal to the Christ anagram in Greek.
- I am grateful to the nuns and particularly to the portress nun for her attention and support that gave me for doing my work on August 8, 2011.